

Part #: 9600
Description: TL Roadside Package Installation
Date: 03/20/2019

Instructions for Installation of the 9600 Roadside Package

1. Prepare the machine so there is easy and safe access to the work area. Remove the ignition key and lower the rear support leg. Maintain all safety related work procedures. Always wear eye and hand protection.
2. Install the wheel chock boxes to the front of the trailer and secure using (4) four (2 per chock box) 3/8-16 x 3/4" serrated flange bolts and (4) four (2 per chock box) 3/8-16 serrated flange nuts. See Figure 1.
3. Remove the mounting hardware from the left side of the discharge stack. See Figure 1.
4. Install the cone holder bracket to the left side of the discharge stack and secure using the hardware removed in step 3.
5. Install the traffic cone holder and secure using (4) four 3/8-16 x 3/4" serrated flange bolts and (4) four 3/8-16 serrated flange nuts. See Figure 1.
6. Tighten all hardware and install traffic cones and wheel chocks.

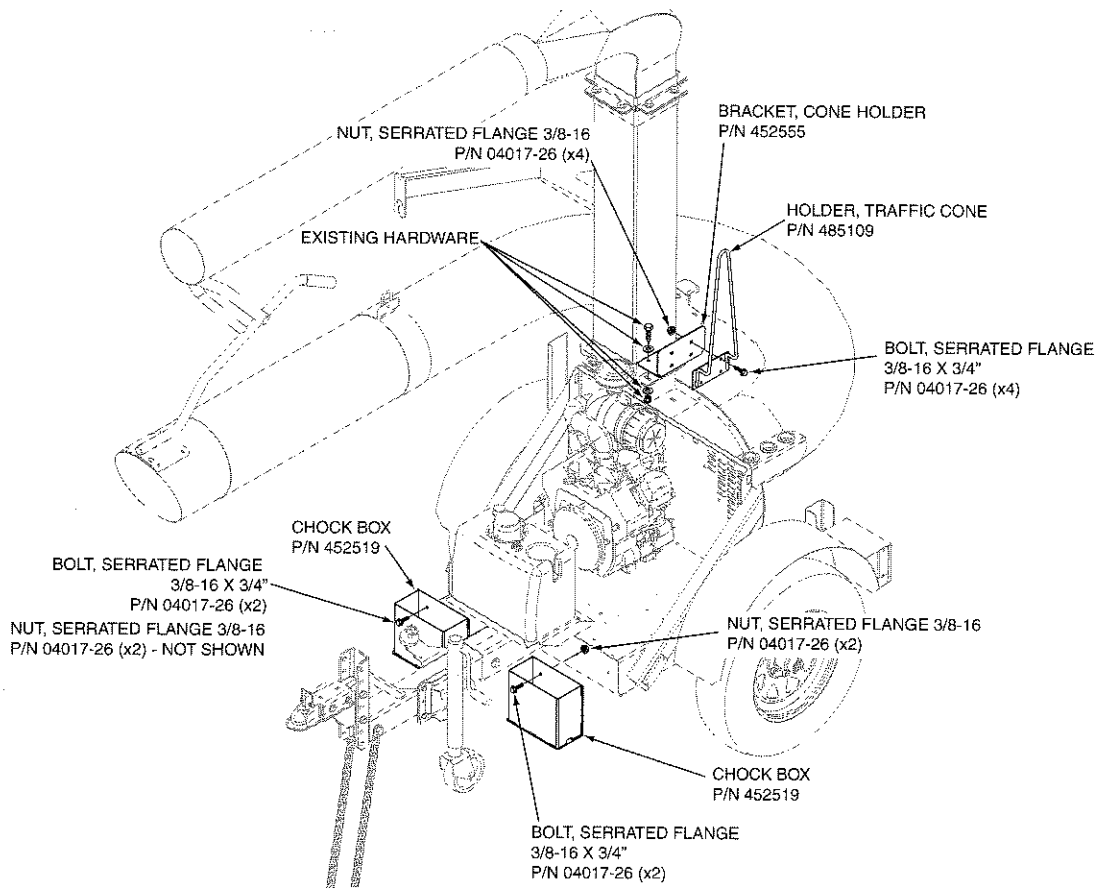

Figure 1. Roadside Package Installation